



approved
4/13/98

SURVEYOR'S OFFICE

Hamilton County

Kenton C. Ward, Surveyor

Phone (317) 776-8495

Fax (317) 776-9628

Suite 146

One Hamilton County Square

Noblesville, Indiana 46060-2230

March 27, 1998

TO: Hamilton County Drainage Board

RE: Marion Blanton Drain

Attached is a petition and plans for the proposed relocation of the Marion Blanton Drain. Mahogany Holding Company is petitioning the relocation. The proposal is to reroute the existing tile drain by outletting the drain into a new open ditch at approximately STATION 113+90. The new open ditch shall run South parallel to the Right of Way of Mill Creek Road for distance of 478 feet and terminate in the John Caraway Arm.

**This line will consist of the following:
478 feet of open Ditch**

The total length of new drain shall be 478 feet. The 690 feet of original drain between STATION 113+90 and STATION 120+80 shall be vacated. This proposal will decrease the drains total length by 212 feet.

The cost of the relocation is to be paid by Mahogany Holding Company. Because the project is to be paid by the petitioner and is within the boundaries of the

petitioner's property, the project falls under the requirements as set out in IC 36-9-27-52.5. Therefore, a hearing is not required for the petition.

The petitioner has provided the Performance Bond for this project with the drain petition for the Bearslide subdivision.

I recommend approval of this proposal by the Board at this time, along with the attached non-enforcement request for the Marion Blanton drain for the Bearslide subdivision.

Sincerely,

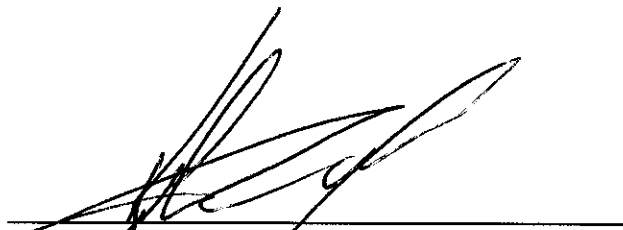

**Kenton C Ward
Hamilton County Surveyor
KCW/no**

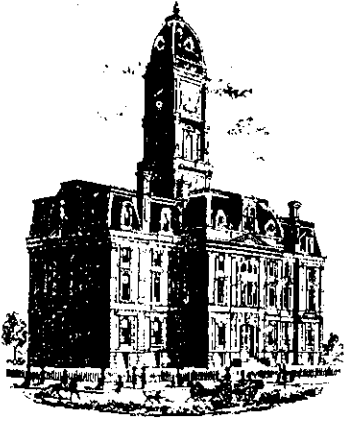

SURVEYOR'S OFFICE
Hamilton County

Kenton C. Ward, Surveyor

Phone (317) 776-8495

Fax (317) 776-9628

Suite 146

One Hamilton County Square

Noblesville, Indiana 46060-2230

To: Hamilton County Drainage Board

April 12, 2000

Re: Marion Blanton Drain

Attached are as-builts, certificate of completion & compliance, and other information for Bearslide Relocation of the Marion Blanton Drain. An inspection of the drainage facilities for this section has been made and the facilities were found to be complete and acceptable.

During construction, changes there were no significant changes made to the drainage plans submitted with my report for this drain dated March 27, 1998.

Therefore, the length of the drain remains at **478 feet**. The net loss remains at **212 feet**.

The non-enforcement for Bearslide Subdivision was approved by the Board at its meeting on November 9, 1998 and recorded under instrument #9809866650.

The project was bonded under the Bearslide Subdivision project. The bond or letter of credit from First of America Bank, N.A., number S981770012; dated February 23, 1998; in the amount of \$212,414.50; was released December 12, 1998.

I recommend the Board approve the drains construction as complete and acceptable.

Sincerely,

Kenton C. Ward,
Hamilton County Surveyor

KCW/slm

HOLEY MOLEY SAYS.
"DON'T DIG BLIND"
 1-800-382-5544
 CALL TOLL FREE
 CALL 2 WORKING DAYS BEFORE YOU DIG

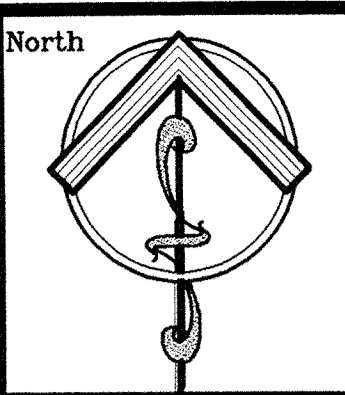

Scale: 1"=60'

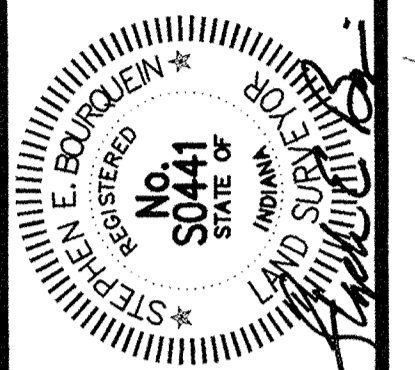

Date	Revision
12/18/97	Revised per comments from Han Co Highway Dept per letter dated 12/15/97.
12/18/97	Revised per comments from Han Co Surveyor per letter dated 12/15/97.
12/29/97	Revised per comments from Han Co Surveyor per letter dated 12/29/97.
1/12/98	Revised per comments from Han Co Surveyor per letter dated 1/12/98.
2/21/98	Revised per comments from Han Co Surveyor per letter dated 2/21/98.

Structure #	Structure Type	Casting Type	Top Casting Elevation	Invert up Elevation	Invert dn Elevation	Connect to	Special Notes
101	48" dia manhole	R-4342	845.79	841.09	840.74	Sir 102	Outlet, (A, B, C)
102	48" dia manhole	R-4342	840.05	839.00	839.00	Sir 101	Outlet, (A, B, C)
200	48" dia manhole	R-4342	846.50	842.89	841.49	Sir 200	Outlet, (A, B, C)
201	48" dia manhole	R-4342	856.00	847.42	847.42	Sir 201	Outlet, (A, B, C)
202	Type "A" modified	R-4342	852.50	850.27	848.75	Sir 201	Outlet, (A, B, C)
203	48" dia manhole	R-4342	855.00	848.61	847.75	Sir 201	Outlet, (A, B, C)
204	Type "A" modified	R-4342	853.50	850.16	849.30	Sir 203	Outlet, (A, B, C)
205	Type "A" modified	R-4342	851.27	849.23	848.93	Sir 203	Outlet, (A, B, C)
206	Type "A" modified	R-4342	851.27	849.47	849.40	Sir 205	Outlet, (A, B, C)
301	Type "A" modified	R-4342	849.10	845.73	845.00	Sir 300	Outlet, (A, B, C)
302	Type "A" modified	R-4342	849.10	846.11	845.98	Sir 301	Outlet, (A, B, C)
401	Type "A" modified	R-4342	850.26	846.85	846.00	Sir 400	Outlet, (A, B, C)
402	Type "A" modified	R-4342	850.26	847.05	846.89	Sir 401	Outlet, (A, B, C)
403	48" dia manhole	R-4342	853.50	848.30	847.30	Sir 402	Outlet, (A, B, C)
404	Type "A" modified	R-4342	853.50	849.20	848.62	Sir 403	Outlet, (A, B, C)
501	Type "A" modified	R-4342	849.50	845.96	844.00	Sir 500	Outlet, (A, B, C)
502	Type "A" modified	R-4342	851.00	847.75	846.25	Sir 501	Outlet, (A, B, C)

All 48" dia manhole structures shall have either a flat top with a 24" diameter hole or a eccentric cone section.
 See Grading Plan for structures that require 6" underdrain connections.
 A - Connect underdrain to structure.
 B - Concrete underdrain to structure.
 C - Rip-rap required. See Grading Plan.

LEGEND

- min fin gd: 000.00' House Site (no pad to be constructed)
- denotes the suggested finish grade to be established around the house (grades may vary around house)
- Proposed finish grade elevation
- Existing grade elevation
- Proposed finish contour
- Existing contour
- Sheet flow drainage
- Point flow drainage / swale
- Proposed 6" underdrain pipe / connector
- Proposed Storm Sewer
- Proposed Storm Street Inlet
- Proposed Storm Manhole / Yard Drain
- Existing Storm Sewer
- Existing Storm Street Inlet
- Existing Storm Manhole / Yard Drain

- ### NOTES:
- The noted minimum finish grade elevations for house areas on the lots are suggested minimums only. Each house is to be individual sited to match slope and grade elevations for their respective lots. There are minimum finish floor elevations required for those lots that abut Bear Slide Creek and tributaries. Those finish floor elevations are to be a minimum of two feet above the 100 year flood elevation as established by the referenced study by SIECO dated September, 1997.
 - Outlet for perimeter drain for Lots #3-14 is provided by Bear Slide Creek / Blanton Drain at the rear of these lots.
 - Any field tiles encountered during construction shall be perturbed connecting to the proposed roadside ditches, underdrains, storm sewers and or ditches as may be required.
 - The contractor shall cap and seal any wells encountered during construction of this project. Well capping and sealing shall meet the requirements of the Hamilton County Health Department and the Indiana Department of Health.
 - See Sheets #6-8 For SSD stub locations for lots.

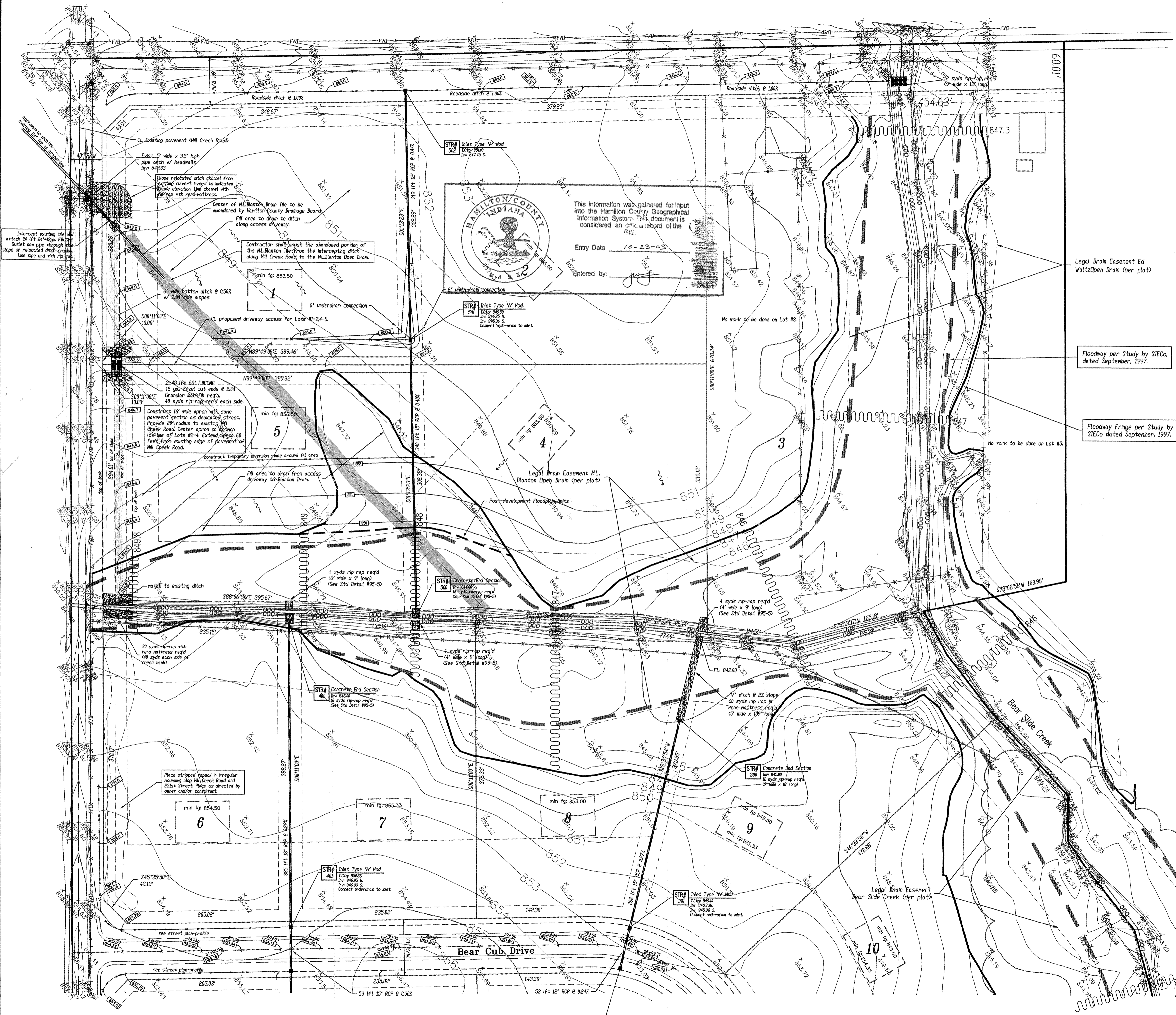

HAMILTON COUNTY
 This information was gathered for input into the Hamilton County Geographical Information System. This document is considered an official record of the
 Entry Date: 10-23-05
 Entered by: [Signature]

Project: **Bear Slide**
 Jackson Township
 Hamilton County, Indiana
 Title: **Grading Plan**
 North Area

Client: **Pendleton Consulting**
 P.O. Box 87
 Pendleton, Indiana 46064-0087
 Phone/Fax (317) 778-6640
Mahogany Holding Company
 1501 Jackson Street
 Anderson, Indiana 46015

Sheet No. **13**
 Date: **11/3/97**

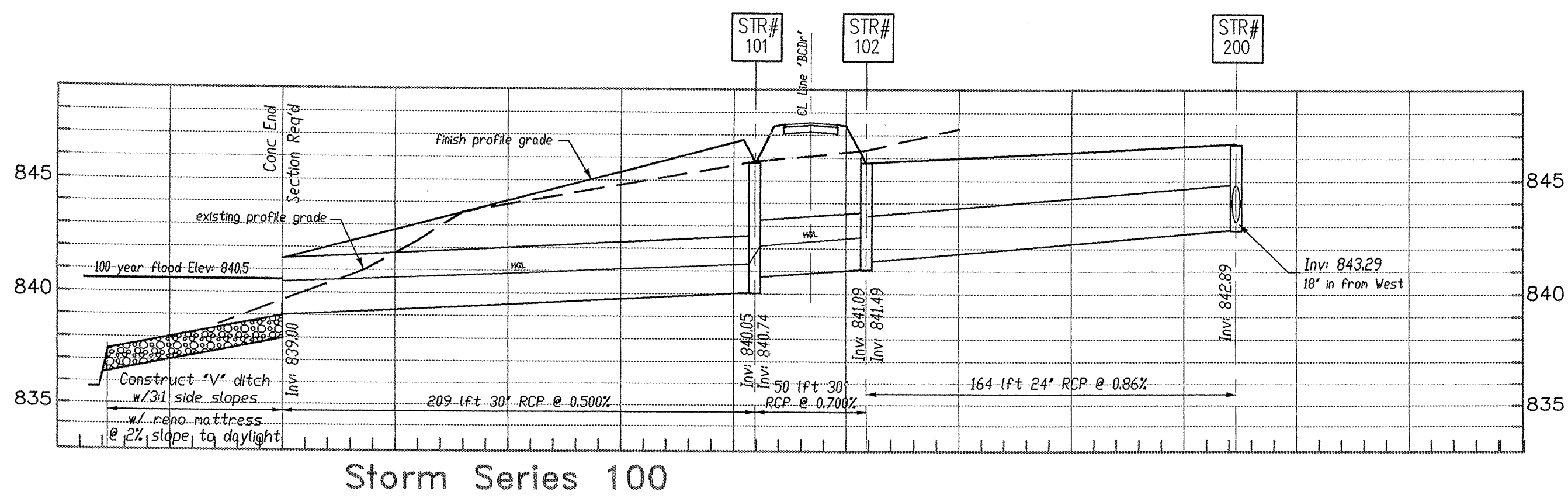

Storm Series 100

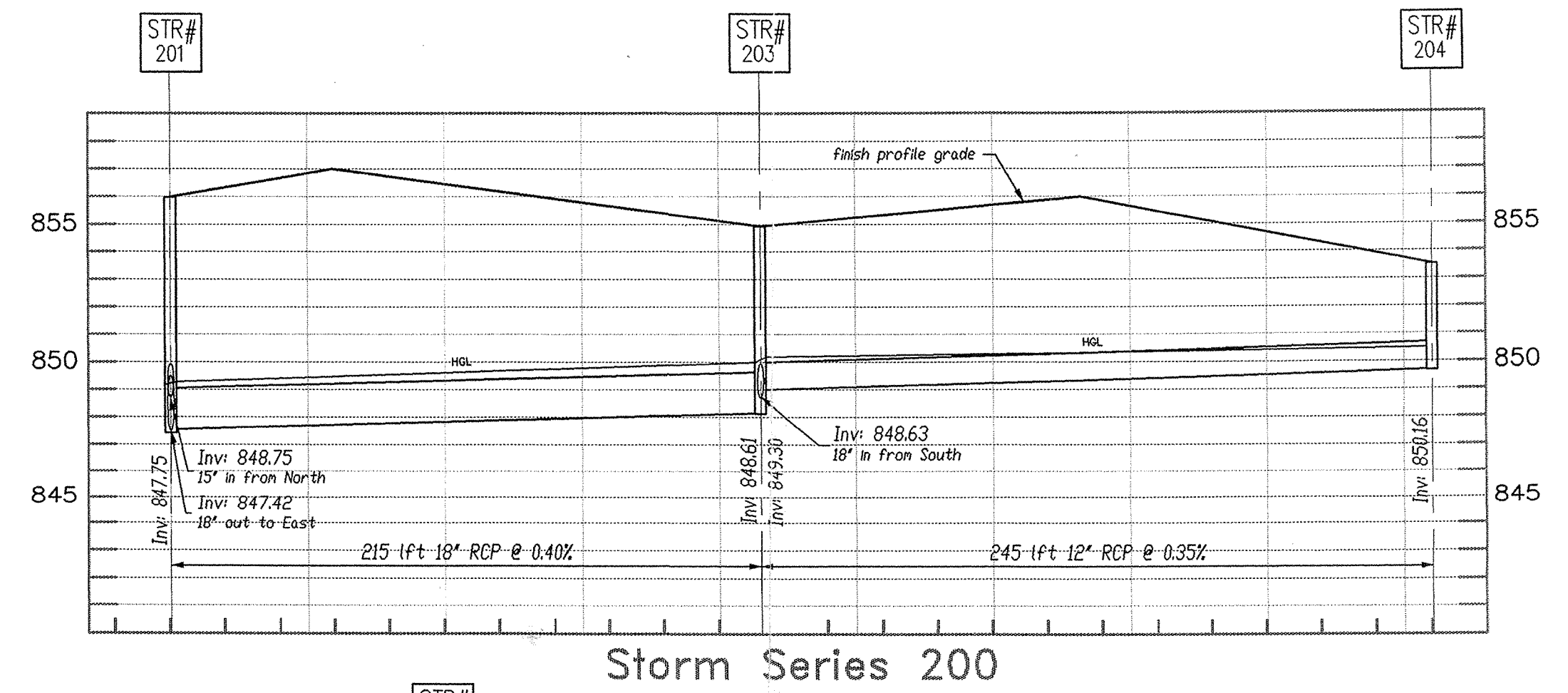

Storm Series 200

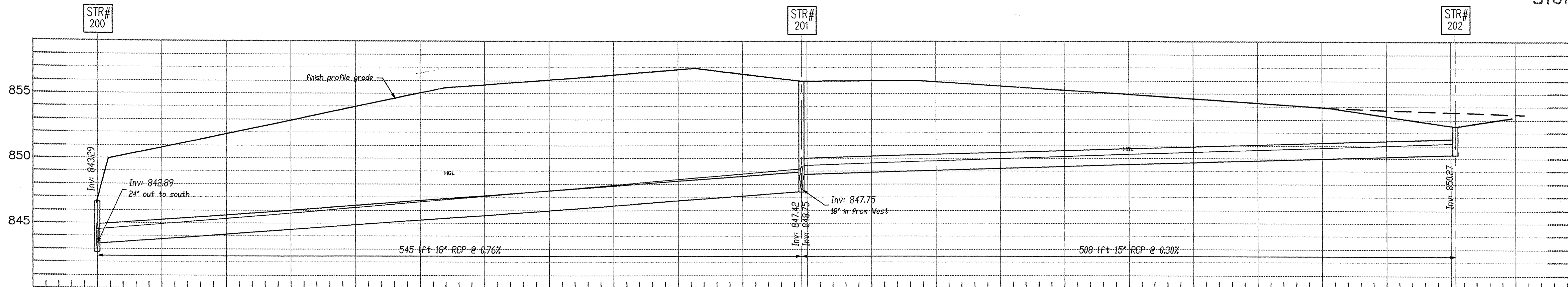

Storm Series 200

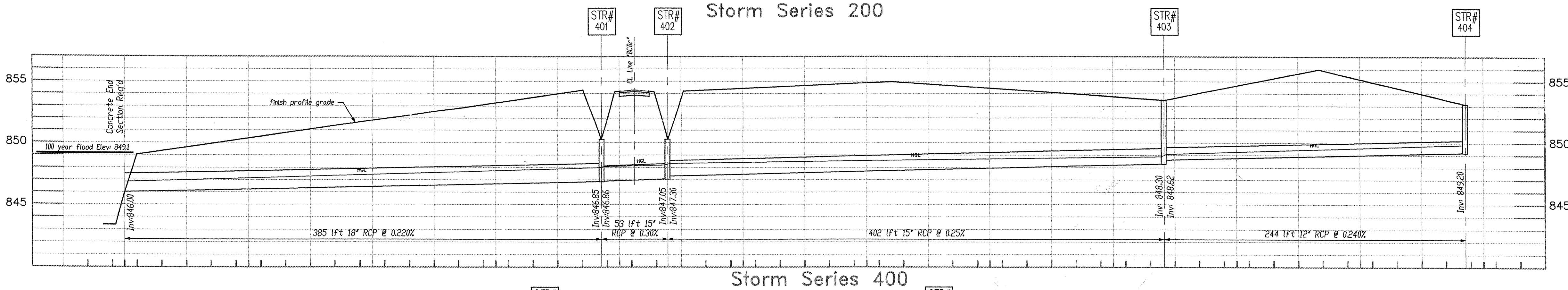

Storm Series 400

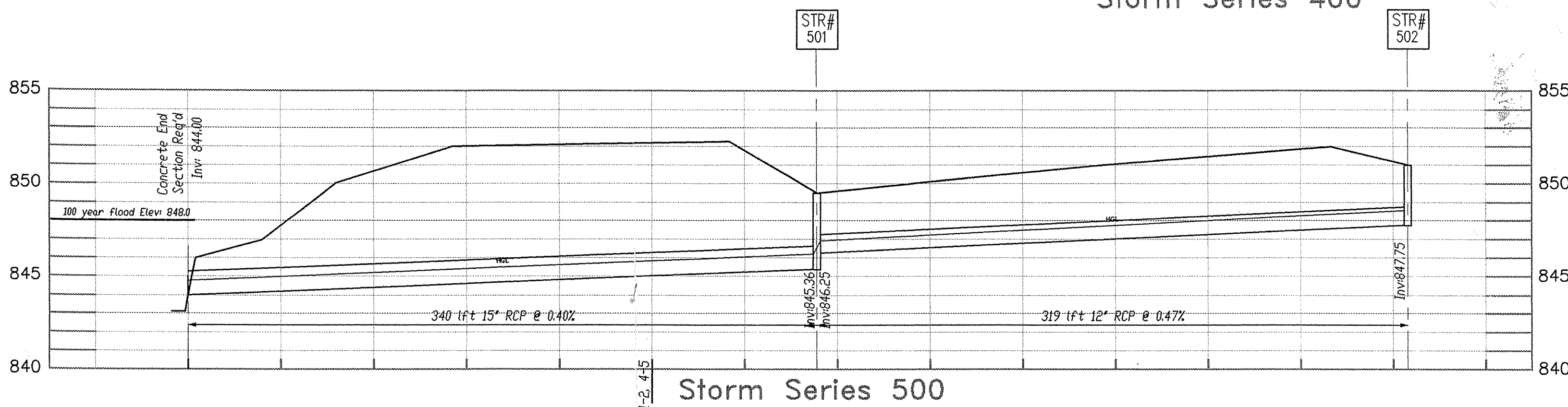

Storm Series 500

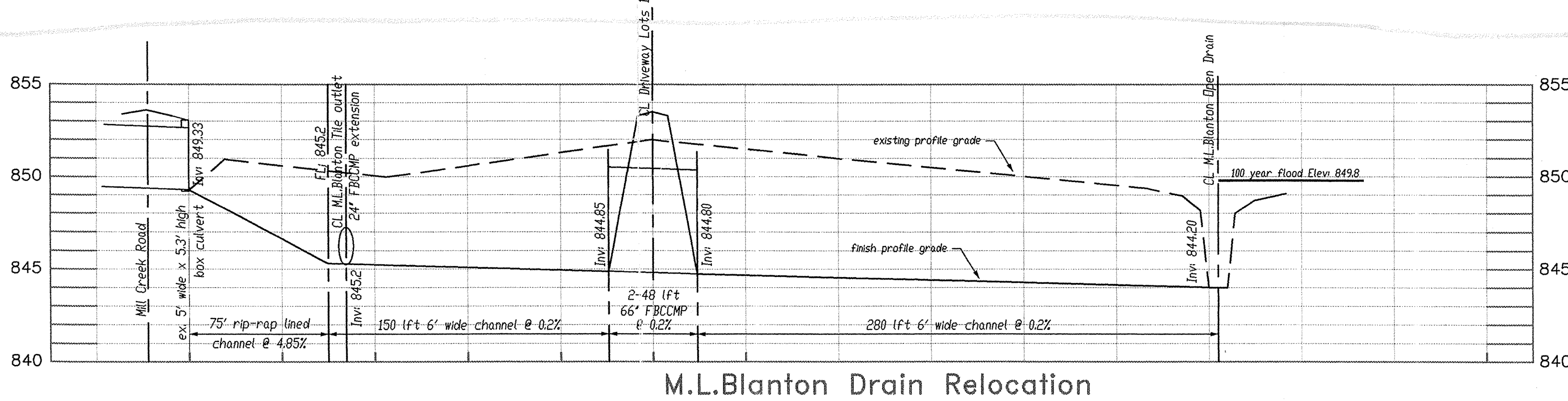

M.L. Blanton Drain Relocation

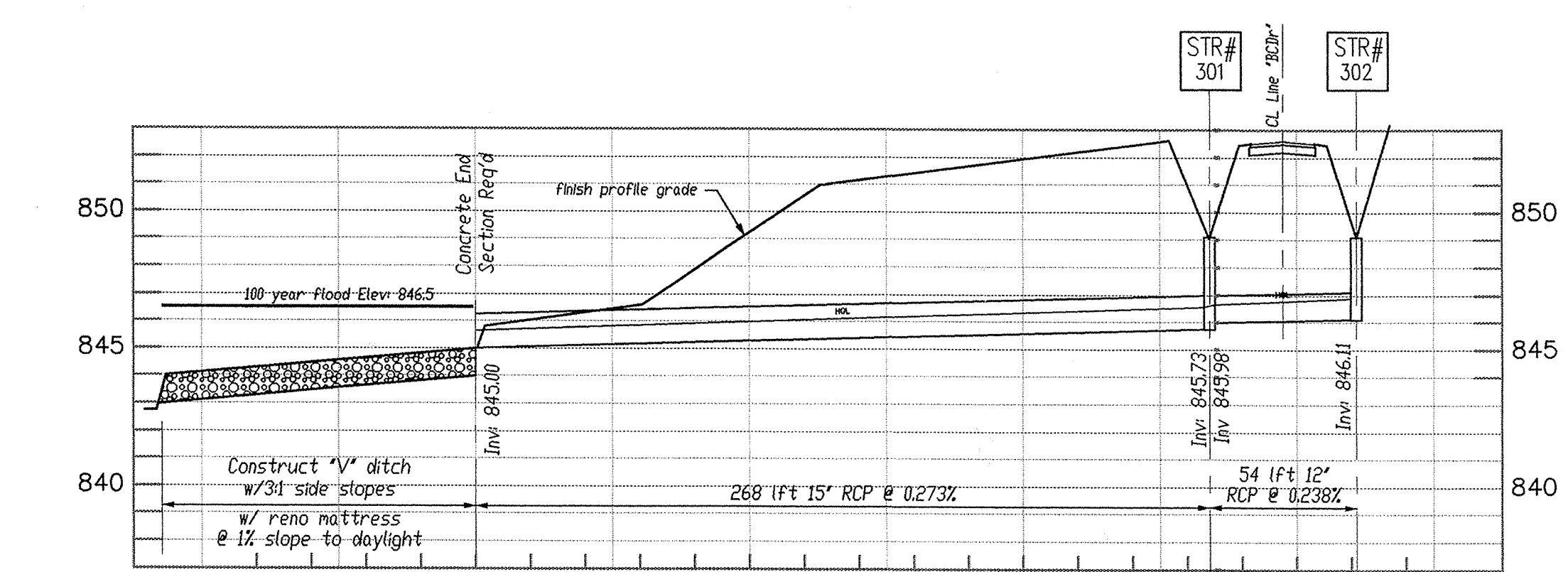

Storm Series 300

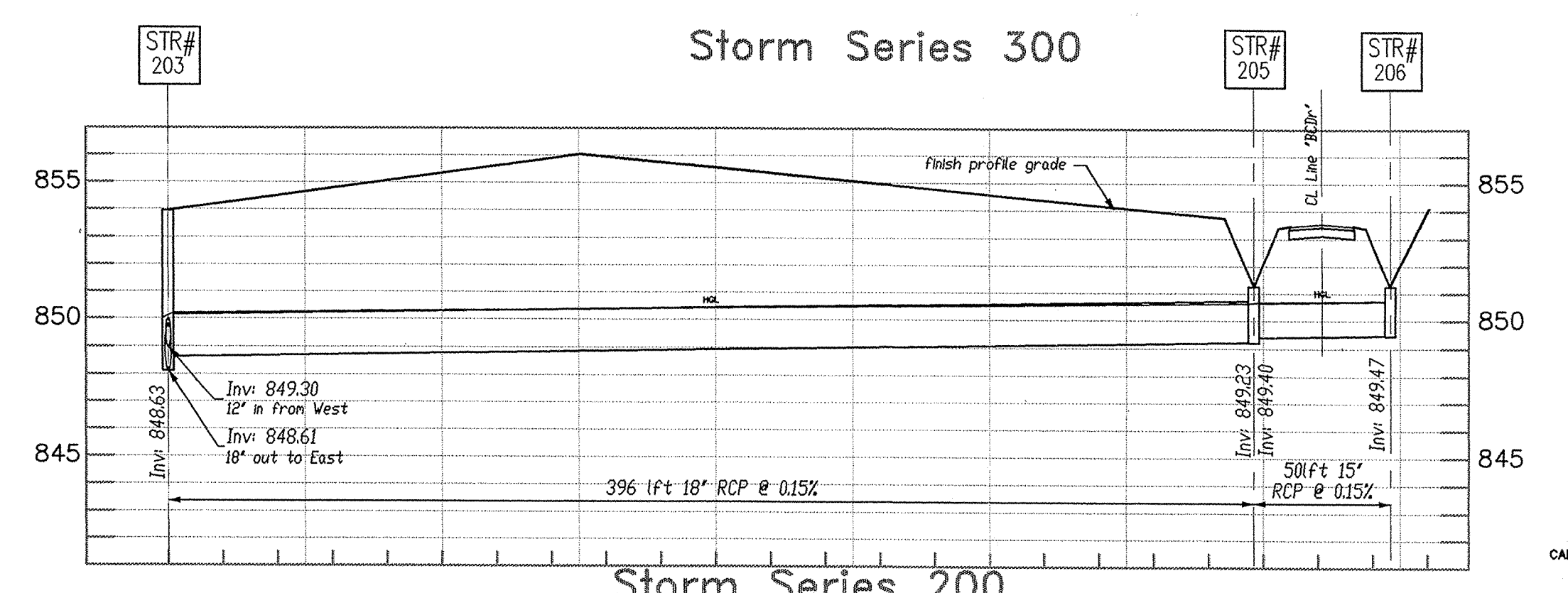

Storm Series 200

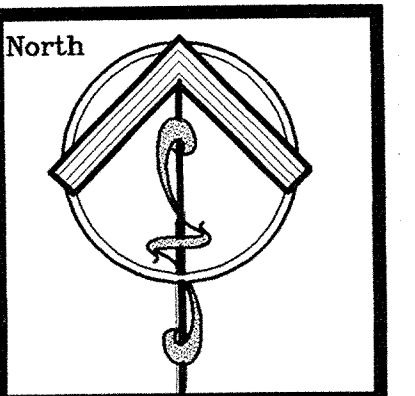

Scale:
Hor: 1"=50'
Ver: 1"=5'

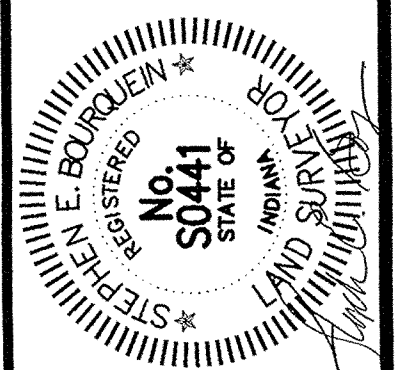

HAMILTON COUNTY
This information was gathered for input into the Hamilton County Geographical Information System. This information is considered an official record of the County.

Entry Date: 10-23-03
Entered by: [Signature]

Date	Revision
12/28/97	Revised per comments from Han Co Surveyor per letter dated 12/22/97.
1/19/98	Revised per comments from Han Co Surveyor per letter dated 1/13/98.

Project
Bear Slide
Jackson Township
Hamilton County, Indiana

Title
Storm Plan - Profile
Middle Area

Client
Mahogany Holding Company
1501 Jackson Street
Anderson, Indiana 46015

Client
Pendleton Consulting
P.O. Box 87
Pendleton, Indiana 46084-0087
Phone/Fax (317) 778-6640

Sheet No. 13

Date 12/9/97

HOLEY MOLEY SAYS.
"DON'T DIG BLIND"

1-800-382-5544
CALL TOLL FREE
CALL 2 WORKING DAYS BEFORE YOU DIG